

SL2.180 Parts List

Note: The SL2.180 is labeled with a sticker that indicates the part number and the **Micro 180®** gas spring is permanently marked with model number, serial number and gas spring part number. Please refer to these when ordering replacement parts.

Rail Plate	Part Number
M	SR56RM12
E	SR56RE50
M1	SR56CM08
E1	SR56CE31

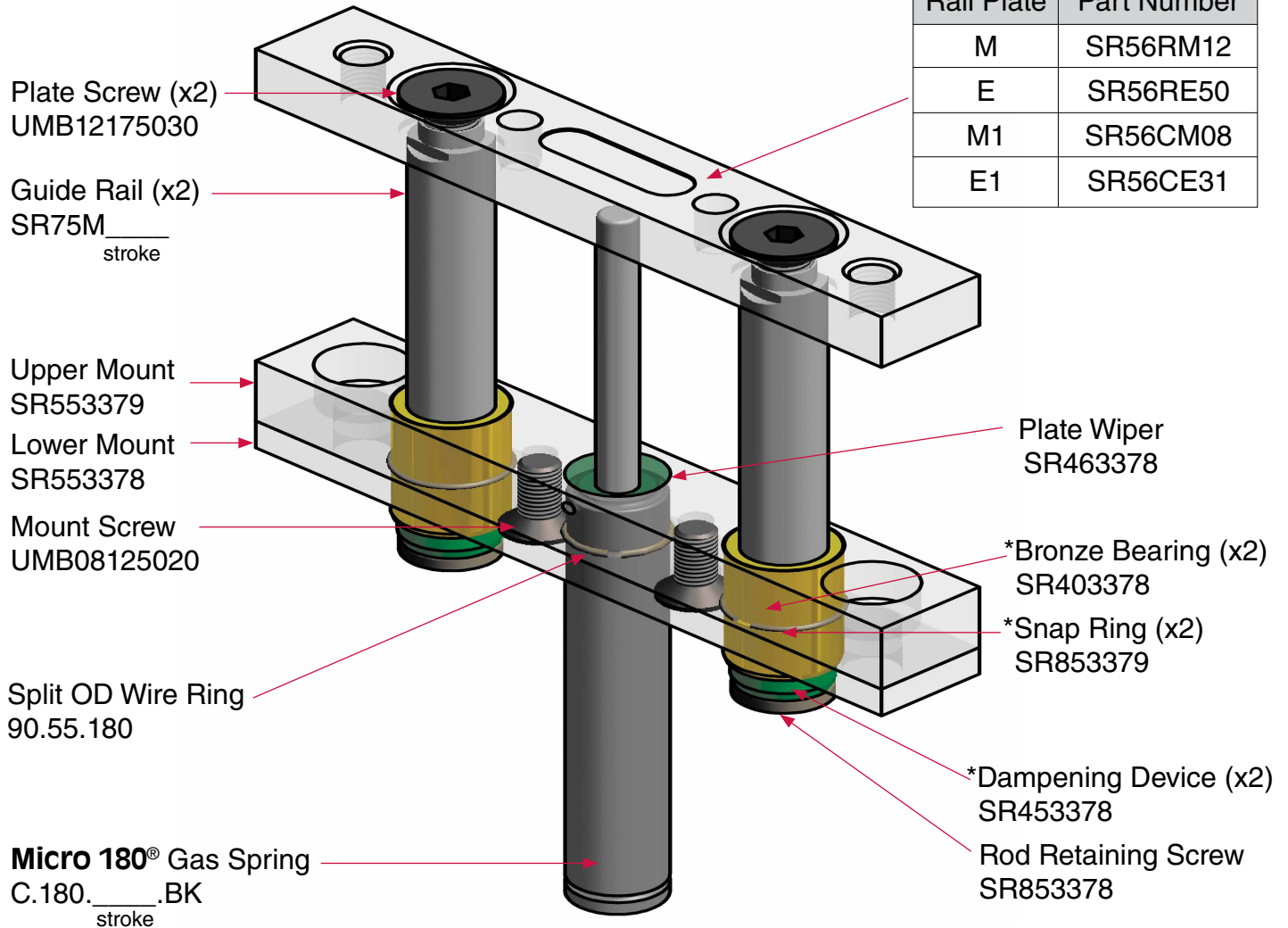

*SL2.180 Repair Kit

SL2.RK.180

Repair kit includes bearing with snap ring (2), dampening device (2), threadlocker capsule (1) and a maintenance manual.

Valve Bleed Tool

90.360.4

Use the DADCO Valve Bleed Tool to slowly discharge the **Micro 180®** gas spring to the desired pressure.



Micro 180® Load Cell

LC-180

Use the **Micro 180®** Load Cell with the Micro Test Stand to determine the force. Request Bulletin No. B07108 for additional information.



SL2.180 Maintenance Instructions

Use in conjunction with DADCO's SL2.090 Maintenance Instructions (B06100)

Please follow the instructions below in conjunction with the SL2.090 Maintenance Instructions (B06100) for proper maintenance of the SL2.180 Two Post Lifter. After reviewing this maintenance guide, if you require any additional training or have any questions please contact DADCO for assistance.

CAUTION: Always wear safety goggles when performing any maintenance work.

Continued from DADCO's SL2.090 Maintenance Instructions

III. Guide Rod Removal



4A. Add 2-3 drops of serviceable threadlocker to the Plate Screws and install them into the Rail Plate using an 8 mm allen wrench to **600 lb.-in / 67 N-m**.

IV. Reassembly

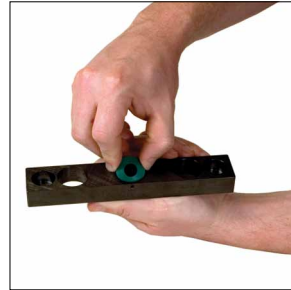

1A. Inspect the Plate Wiper located in the Upper Mount for wear. If the Plate Wiper, (SR463378, sold separately), is damaged it must be replaced.



1B. Install the Upper Mount with Bronze Bearings onto the Guide Rails. Add 2-3 drops of serviceable threadlocker to each Rod Retaining Screw. Install the two screws with Dampening Devices using an 8 mm allen wrench to **600 lb.-in / 67 N-m**.

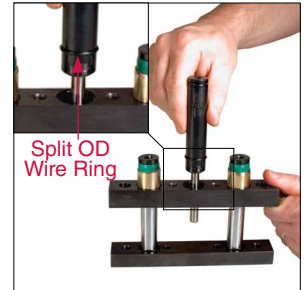

2. Install the **Micro 180**[®] Gas Spring with Split OD Wire Ring, (90.55.180, sold separately), into the Upper Mount. To verify the force of the **Micro 180**[®] Gas Spring before installation, refer to the Micro Load Cell Bulletin #B07108.

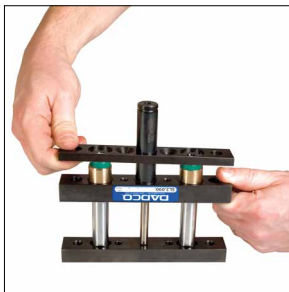

3. Install the Lower Mount over the **Micro 180**[®] Gas Spring.

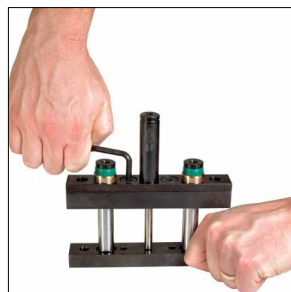

4. Install the two Mount Screws using a 5 mm allen wrench to **175 lb.-in / 20 N-m**.



SL2.180 Nitrogen Gas Spring Two Post Lifter